

UW PROJECTS

Holistic Hydro-Wellness Solutions



u

New Dawn of Hydro based wellness

W





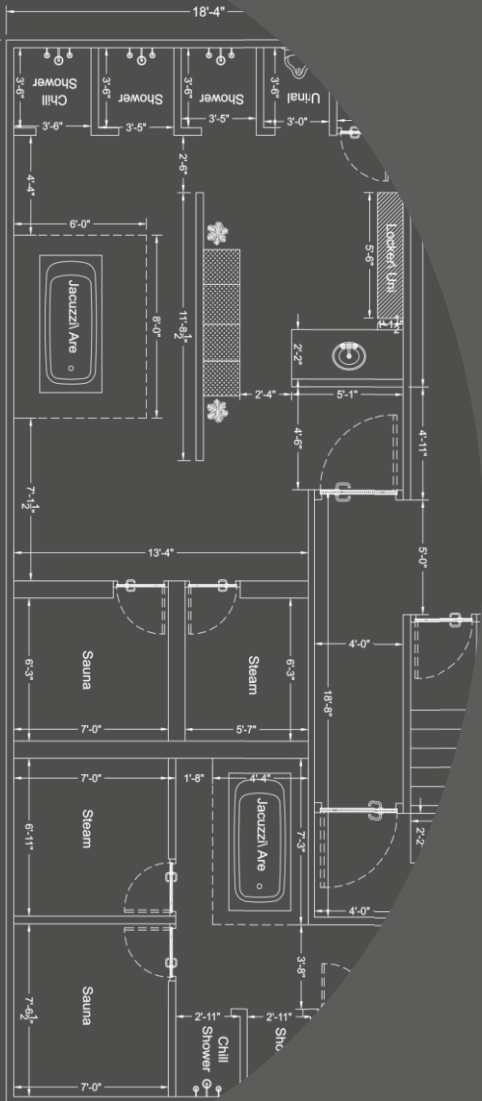

LW PROJECTS

- Philosophy
 - History
 - Today
- Path to Creation
- Methodology behind Creation
 - Difference in Creation
 - Our clients



UW PROJECTS

WE UNDERSTAND WATER AND ITS BENEFITS...

We know how water can bring about wellness.

With this as our modus operandi, we have nurtured our technology & its due integration.

Spa Pool Villa

Commercial Spa Projects

Temperate Pools

Thermae

Steam & Sauna

Luxury Whirlpools & Showers

Landscaping

TECHNOLOGIES BACKED BY TWO DECADES OF R&D

Since our inception in 1994, we have been constantly focusing on R&D and innovation to be able to control all characteristics of water & inturn project costs. Today, we have developed proprietary technologies to move, store, control pressure, form, quantity, temperature and quality of water in an energy efficient way.

Through our technology, we control the following four characteristics of water to drive perfect wellness:



Temperature



Pressure



Quality



Quantity





UW HISTORY

1994

Mr. Rajesh Chadha, our founder, developed first non-pressure based steam generator through his knowledge and experience of heating elements

1995 - 2000

Pioneered steam bath systems suitable for residential installations and set up organizational systems for after sales support

2000 - 2004

Gained expertise around other spa technologies like swimming pools, water features, sauna, water conditioning systems, designing and civil execution, etc.

2005 - 2010

Multiple residential and commercial projects successfully commissioned across India.
2007: First pool villa commissioned which included: swimming pool, whirlpool, air jet, steam, sauna and automated shower system

2010 - 2013

Developed expertise in spa management based on hands-on experience. R&D for understanding of “Thermae” a therapeutic technique to alter body temperature through water

2014 - 2015

The only company in India to develop “Thermae” for both residential and commercial projects.
End to end water management technologies developed





We specialize in the design and development of wellness and spa projects for hotels, boutique spas and select high end residences, from concept to commissioning.

Our sensational concepts and designs go beyond realm of aesthetic beauty and infuses technological efficiency through optimization of resources, energy and water.

"Our body is capable enough to cope with every disorder, until it loses its Natural balance"
Rajesh Chadha



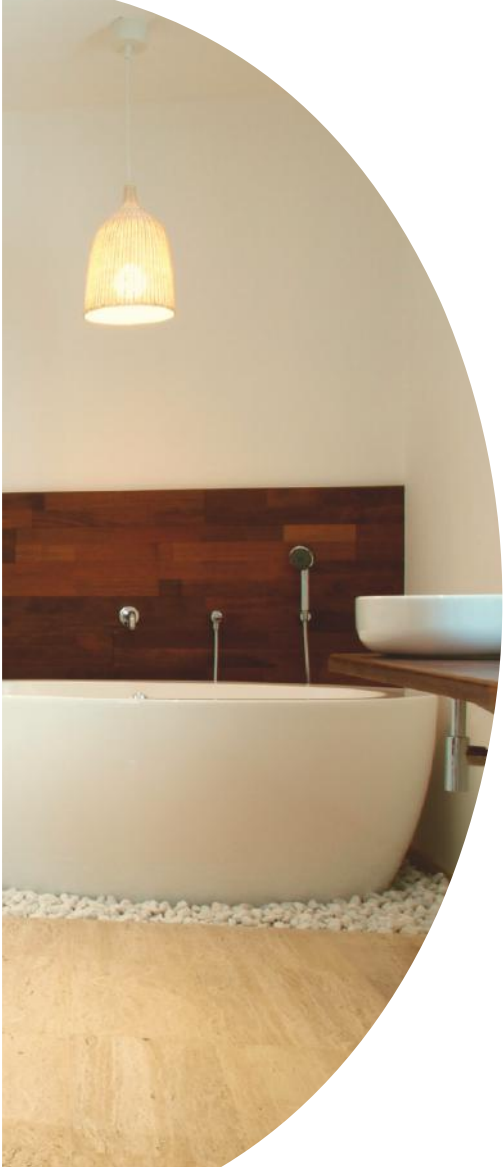

Our able team of Industry experts bring your *ideas*
& *visions to life.*

We co-create unique brilliant concepts with superior
operational efficiency.

Project Cost Control
Holistic Creation
Technology Integration
Commercially Viable
End-to-end Support
Value Driven
Low Capex



UW PATH TO CREATION

We have a keen sense of spa.

Our sensibilities in spa creation are derived from years of experience with spa concepts and live experiences with equipment, technology and its due integration. All these really are at the heart of a successful spa creation.

We take pride in our sensibilities that take our patrons closer to nature through use of our technologies. We have sharpened our sensibilities that are key to wellness facility creation.



UW PATH TO CREATION

Hydro Sense

The application of water through various methods, temperatures and pressures can cause therapeutic and healing effects. Our handcrafted hydrotherapy create a sense of wellness through water - *the true meaning of Spa (Salus Par Aqua)*.

Swimming Pool
Temperate Pools
Thermae
Hammam
Whirlpool & Jacuzzi

Thermo Sense

Altering the body temperature in real time can cause ultimate relaxation and lasting wellness. Harnessing our technological prowess our concepts revolve around creating powerful thermo-sensory experiences, from ice to steam, that delivers complete sensory indulgence.

Steam Bath
Sauna Bath
Ice Showers
Snow Rooms





UW PATH TO CREATION

Nature Sense

At the end of a day, a beautiful sunset in the distance can cause more happiness than the view of our everyday skyscrapers. Because nature is the essence of human existence, it is imperative for a spa creation to incorporate an understanding of the elements of nature.

Salt Room

Crystal Room

Heated Stone Room

Fire Feature

Aroma

Lighting Feature

Natural Massage Therapy

Space Sense

We do not need Darwin to explain the importance of space to human existence. The feeling of space drives human actions and attitudes. A keen understanding of this sense is imperative to create a beautiful yet efficient wellness facility.

Floating Lounges
Submerged Spaces
Aqua Relaxation
Thermae Shower Pods



A photograph of an outdoor lounge area featuring grey wicker armchairs with orange and white cushions, situated next to a swimming pool with clear blue water. The background shows lush green foliage.

UW METHODOLOGY BEHIND CREATION

1. OBJECTIVE STUDY

A clear understanding of expectations of the stakeholders is necessary to create a successful partnership. The foundation of a fruitful long term association.

2. CONCEPT CREATION

Based on objectives, the concept is created. Interiors, treatments, therapies and user experience is deliberated to come to a final concept & theme

3. PLANNING & DESIGN CREATION

Based on the theme, the right resources and expertise are channelized. Architecture & interiors team takes over to create a design.

4. CONSTRUCTION

(Plant Room & MEP Works Equipment Installation & Commissioning)

The engineering team takes over this stage and starts with review of designs. Project is managed and construction supervised to remove redundancies & have a strict control over project costs.

5. PREHANDOVER

(for Commercial Spa Projects)

The engineering team trains the spa staff in preventive maintenance and operation of spa systems and equipments. Technology components are thoroughly tested before handover.

6. POSTOPENING

(for Commercial Spa Projects)

Ongoing customer support team keeps engaged to ensure zero down time. Operational and maintenance systems are periodically checked and maintained.

TYPICAL PROJECT CHALLENGES

- Innate inefficiency due to in experienced design
- Multiple vendors for various work expense groups
- Spa equipment mostly under maintenance or down time
- Reduced to a "massage spa"
- No guarantee of safety of installed technologies
- Low longevity & high cost of ownership

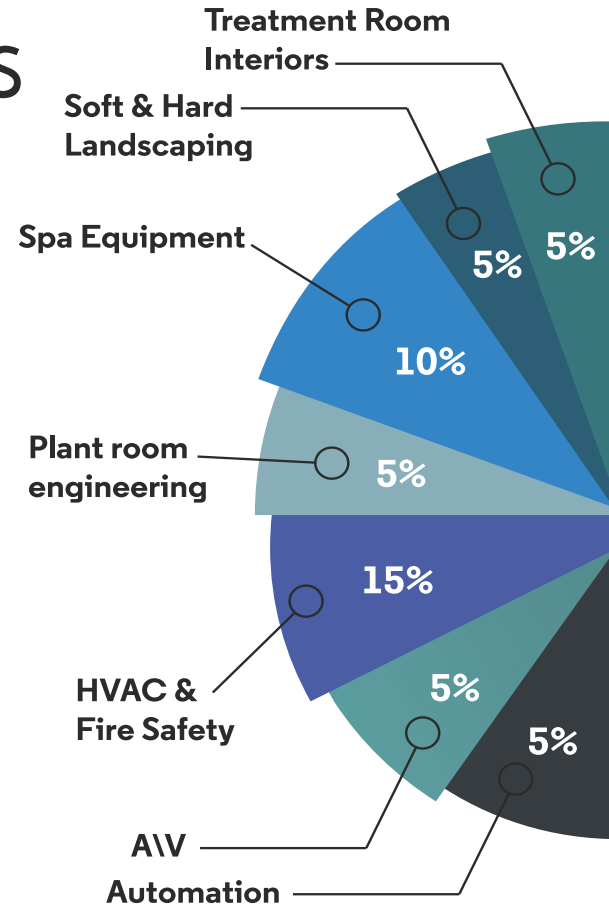

* Typical Spend Allocation

Architecture &
Interiors

50%

UW ADVANTAGE

Efficient & optimized set up due to experienced design team

Single vendor for all functions

Zero downtime guaranteed

Unique & inimitable aqua spa creation

No hidden cost at the time of implementation

Project monitoring & cost control



UW CLIENTS





www.ushmayawellness.com